

# PORODO



## Porodo

### Fiora Smart Portable Kettle

SKU: PDSY619ABG

# **Table of Contents**

Product Overview	2
Specifications	2
Safety Precautions	3
Product Components & Controls	4
Operating Instructions	5
Cleaning and Maintenance	7
FAQ	7
Troubleshooting	8
Disposal	9
Warranty	10
Contact Us	10

## Product Overview

The Porodo Fiora Smart Portable Kettle is a compact and travel-friendly device with a 600ml capacity. It features a digital temperature display, allowing you to easily adjust the temperature from 45°C to 100°C. The kettle also has an automatic heat preservation function, keeping your beverage warm for up to 12 hours. With its simple on/off function and LCD screen that shows the current temperature, it offers a convenient solution for brewing and maintaining the ideal temperature while on the go.

## Specifications

Material	304 Stainless Steel
Input	5V/3A
Rated Voltage	220V
Rated Frequency	50Hz
Rated Power	500W
Capacity	600mL
Charging Interface	USB-C
Product Weight	0.75kg
Product Size	87 x 87 x 248mm
Model Number	PDSY619A

## Safety Precautions

Please follow these safety precautions when using your kettle:

- 1.** Before connecting the kettle to a power source, ensure the voltage marked on the bottom of the kettle and the base unit matches the voltage in your home.
- 2.** To avoid the risk of fire, electric shock, or personal injury, never immerse the cord, plug, base, or kettle in water or any other liquid.
- 3.** Do not use any accessories not recommended by the manufacturer, as they may cause fire, electric shock, or injury.
- 4.** Keep the kettle (including the base) away from heat sources such as stoves, ovens, and radiators.
- 5.** Place the kettle on a dry, flat, and stable surface.
- 6.** Unplug the kettle from the outlet when not in use and allow it to cool before cleaning.
- 7.** Never fill the kettle above the "MAX" line to prevent overflow and possible scalding.
- 8.** Before first use, fill the kettle with cold water, boil it, then pour it away and rinse with cold water.
- 9.** To avoid scalding, do not move the kettle while it is boiling.
- 10.** Always supervise children near the kettle. Do not allow them to use or play with the kettle.
- 11.** Do not operate the kettle if it has a damaged cord or plug, or if it malfunctions, is dropped, or damaged in any way.

### **Warning:**

- a.** After boiling, allow the kettle to cool for 3 minutes before unscrewing the lid.
- b.** Do not move the kettle while it is in use.
- c.** Be cautious of the high temperature when pouring the water or drinking it.
- d.** This kettle is not intended to heat soya-bean milk, milk, rice paste, coffee, cereal, or other high-density drinks, and cannot be used to cook porridge.

e. When boiling water continuously, there may be a small amount of steam coming from the lid to help prevent burns.

## Cleaning Tips

- a. The kettle should not be washed in water.
- b. Avoid using steel balls or other hard cleaning materials.

## Product Components & Controls

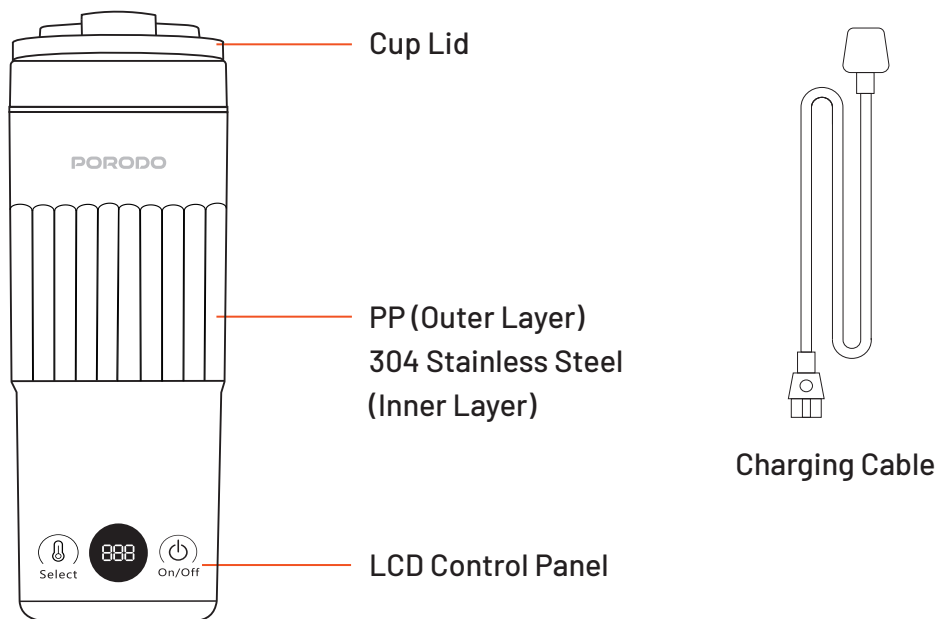

## Control Panel

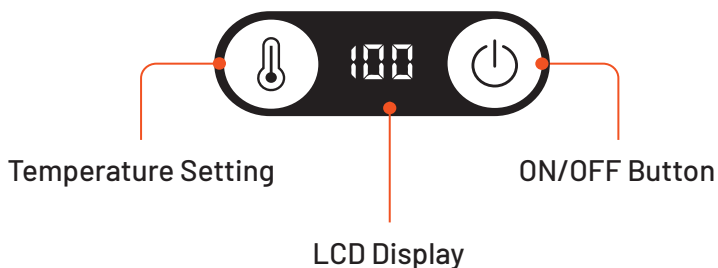

**Temperature Setting:** Set the temperature to 100°C, 85°C, 75°C, 65°C, 55°C, or 45°C for your ideal brew.

**LCD Display:** Displays the selected temperature and real-time boiling water temperature.

**ON/OFF Button:** Press for one second to turn the kettle on or off.

## Operating Instructions

- 1. Add Water:** Ensure that the water is filled below the "MAX" line and that the kettle is closed properly. Do not exceed the maximum fill line to avoid spills and ensure safety during use.
- 2. Plug in Power Cable:** Connect the power cable and ensure the kettle is in standby mode with the power indicator on.

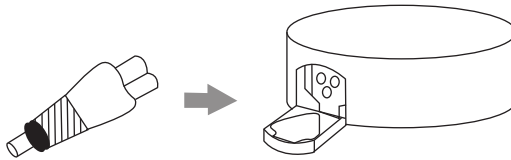

### 3. Boil Water

Follow these steps to boil water:

- a.** Set the desired temperature for boiling.
- b.** The LCD will display the selected temperature.
- c.** Press the ON/OFF button to begin heating.
- d.** The kettle will heat to the selected temperature and will alert you with three beeps when it is finished.



#### 4. Temperature Multi Settings

To adjust the temperature:

- a. Press the temperature setting button to choose your desired temperature.
- b. The LCD will display the set temperature.
- c. Press the button again to select your preferred temperature from 100°C, 85°C, 75°C, 65°C, 55°C, or 45°C.
- d. The kettle will heat to the set temperature and alert you with three beeps once the process is complete, after which the kettle will switch to standby mode.



#### 5. Hold Temperature Setting

In the energized state, when one of the temperatures (45°C, 55°C, 65°C, 75°C, or 85°C) is selected, the kettle will automatically enter the heat preservation mode for 12 hours after reaching the set temperature. In 100°C mode, the keep-warm temperature will be 55°C, with a keep-warm time of about 12 hours.



#### Notice:

- a. If you want to stop heating when the water is boiling, simply press the ON/OFF button to stop it.
- b. The kettle will display the water temperature in real-time while heating.
- c. When boiling water with an open lid, the maximum water volume is 600ml, up to the maximum line in the kettle.
- d. It is recommended to boil water with the lid closed. In this case, leave the kettle for 3 minutes after the water has heated, then open the lid.
- e. When the altitude is over 1500 meters, the lid must be opened to boil water.

## Cleaning and Maintenance

### Cleaning:

1. Unplug the kettle and allow it to cool before cleaning.
2. Wipe the kettle and base with a soft cloth or sponge. Ensure that the electric socket on the underside of the kettle remains dry.
3. Dry all parts thoroughly after each use.
4. Never immerse the kettle or power base in water.

### Descaling:

Over time, depending on your water supply, limescale may form on the heating element, which can reduce the kettle's heating efficiency. To avoid this, empty the kettle after each use and do not leave water inside, as it can contribute to mineral buildup.

Required Materials:

1. Mix a solution of  $\frac{3}{4}$  parts water and  $\frac{1}{4}$  part vinegar or lemon juice.
2. Pour the solution into the kettle and close the lid.
3. Bring the solution to a boil and let it sit for 5–8 hours.
4. Repeat as needed.

**Note:** Do not use steel wool or abrasive scouring pads, as these may scratch the kettle.

## FAQ

**Q:** What should I pay attention to when using it for the first time?

**A:** For first-time use, please:

1. Read the instruction manual carefully and ensure that the power cord, plug, and kettle are in good condition.
2. Place the kettle on a stable, level surface and check that it works properly.
3. Fill the kettle with water up to the "MAX" line and make sure the lid is securely closed.

4. Set the temperature to 100°C and press the ON/OFF button to start boiling the water. The kettle will automatically turn off once boiling is complete.

**Q:** How long does the water temperature last after unplugging? Can I use it as a thermos cup?

**A:** This portable kettle can keep water warm for about 2-3 hours after being unplugged and can be used as a thermos.

**Q:** Can I use it for traveling?

**A:** The rated voltage of the kettle is 220V.

**Q:** What should I do if it does not work properly or accessories are missing? Is there a warranty on the kettle?

**A:** If there are any issues with the product or accessories, or if something is missing, please contact us. Our products come with a lifetime warranty, and we will address your issue as quickly as possible.

## Troubleshooting

Issue	Potential Causes	Solutions
LCD does not light up	1. The power cord is unplugged	Ensure the power cord is plugged in
	2. The circuit board is damaged	Contact customer support for assistance
Water will not boil	1. The water recently finished boiling, and the temperature setting has been turned off	Wait for the water temperature to drop before boiling again
	2. The circuit board is damaged	Contact customer support for assistance

Kettle does not turn off automatically when water is boiled	The circuit board is damaged	Contact customer support for assistance
Water overflows	1. The lid is not open when boiling water, or the water level is above the MAX line	Always keep the lid open when boiling water, and never exceed the MAX fill line
	2. The temperature probe is damaged	Contact customer support for assistance
LCD displays "E1/E2"	The circuit board is damaged	Try unplugging and plugging the power cable back in. If the issue persists, contact the seller for further assistance
LCD displays "E3"	Dry burning caused by insufficient water	Ensure the kettle is properly filled with water before turning it on to avoid dry burning.

## Disposal

This product must not be disposed of as unsorted household waste. It is important to separate such waste for proper treatment and recycling, in compliance with local waste management regulations.



## **Warranty**

Products that you buy directly from our **Porodo** website or shop come with a 24-month warranty.

When you buy **Porodo** products from any of our approved sellers, you only get a 12-month warranty. If you want to extend this warranty, go to our website at <https://www.porodo.net/warranty> and fill out the form with your information. Don't forget to upload a picture of the product too. After we've checked and accepted your request, we'll send you an email to confirm that your product's warranty has been extended.

For more info, please check:  
<https://www.porodo.net/warranty>

## **Contact Us**

If you have any questions about this Privacy Policy, please contact us at:

**info@porodo.net**

Website: <https://www.porodo.net/>

Service Support: **support@porodo.net**

Instagram: **porodo**