

porodo



Porodo

**Lifestyle 6 in 1 Rechargeable Grooming Kit
with Nose Trimmer Four Detachable Heads**

SKU: PD-LSR6N1GK-BK

Table of Contents

Caution.....	2
Warning.....	2
Features.....	3
Components.....	3
Specifications.....	3
Instructions for Use.....	4
A. Charging the Device.....	4
B. Digital Battery Level Indicator.....	4
Battery Life Optimization Guide.....	5
Trimming Guide.....	5
Nose and Ear Hair Removal.....	8
Cleaning and Maintenance.....	8
Replacing the Cutting Unit.....	10
Safety Precautions.....	11
Storage	12
Warranty.....	13
Contact Us.....	13

Before installing and using the product, please carefully read this User Manual to guarantee correct usage and keep it secure for future reference.

Caution

1. Utilize this appliance strictly for its intended purpose as delineated in this manual.
2. Refrain from employing this product if it malfunctions.
3. Do not continue usage if the appliance has sustained damage from being dropped or submerged in water.
4. Ensure the appliance remains dry at all times.
5. The hair clipper is approved for use by minors starting from the age of 3 years, provided they are under adult supervision.
6. This hair clipper is also suitable for children 8 years and older, and for individuals with limited physical, sensory, or mental capacities, or a deficiency in experience and knowledge, on the condition that they are offered appropriate guidance or instructions regarding the safe operation of the appliance and are informed of the safety risks involved.
7. The appliance must not be treated as a toy by children.
8. Maintenance and cleaning of the appliance by children must be conducted under adult supervision only.

Warning

1. Only utilize the detachable supply unit provided with this appliance for the purpose of recharging its battery.
2. This appliance must exclusively be operated with the power supply unit included upon purchase.
3. The batteries contained within this appliance are designed to be non-replaceable.
4. Before disposing of the appliance, ensure that the battery is removed.
5. The appliance should be detached from the electrical mains prior to the removal of the battery.
6. Dispose of the battery in a manner that is safe and adheres to local environmental regulations.
7. The rechargeable battery should only be removed when the appliance is being discarded and must be done by a qualified professional.

Features

1. Easy to Install the Cutting Blade.
2. This trimmer is designed with a convenient hanger hook for easy storage.
3. Equipped with 45° angle stainless steel Ultra-Sharp Blades for quick, smooth trimming.
4. Easy Clean, Removable Stainless Steel Precision Blade
5. The precision blade is removable and washable, ensuring hygiene and easy maintenance.

Components

1. T-Blade Trimmer Attachment
2. Slide On/Off Switch
3. Battery Level Indicator
4. Socket for Appliance Plug
5. Ring Hanger
6. Nose Hair Trimmer Attachment
7. Guide Combs (3mm, 6mm, 9mm, 12mm)
8. Charging USB Cable
9. Oil Bottle
10. Cleaning Brush
11. Comb



Specifications

Product	Rechargeable 6in1 Grooming Kit
SKU	PD-LSR6N1GK-BK
Blade	Stainless steel
Motor	DC 3.2V
Battery	Li-ion 600mAh
Charging Time	2 hours
Working Time	120 minutes
Charging Cable	USB Type-C (1m)

Instructions for Use

A. Charging the Device

1. Ensure the Trimmer is fully charged prior to initial use or after an extended period of inactivity.
2. Avoid charging, recharging, or operating the Trimmer at temperatures below 40°F or above 95°F, as extreme temperatures can negatively impact the battery's lifespan.
3. In the event of high temperature, pressure, or humidity, allow the Trimmer to cool down for 30 minutes before use.
4. Frequent recharging of the Trimmer may lead to a shortened battery life.
5. Ensure that the Trimmer is switched to the OFF position. (Refer to Figure 1).
6. For USB charging, insert the USB charging pin into the appliance, then connect the USB cable to your computer or any USB adapter, and finally connect the adapter to the electrical mains. (See Figure 2).

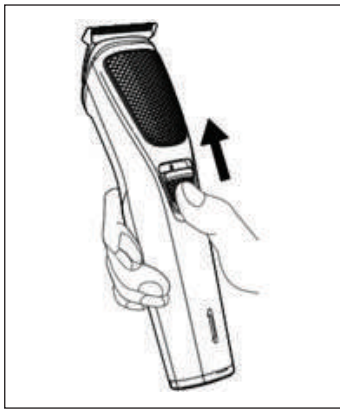

Figure 1

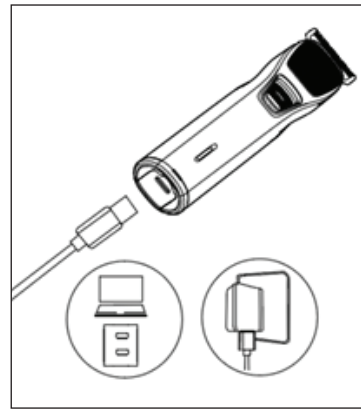

Figure 2

B. Digital Battery Level Indicator

1. During charging: The charging indicator will blink red.
2. When indicating a low battery (less than 10 %): The charging indicator will flash red.
3. Upon full charge: The battery capacity will read 100 and the red indicator light will turn off.
4. It requires approximately 2 hours to fully charge the Trimmer, which will provide up to 120 minutes of cordless use.
5. After charging, disconnect the cable and unplug it from the electrical outlet.

Battery Life Optimization Guide

1. Subsequent to the initial charge, avoid recharging the Trimmer intermittently between use. Instead, continue to use it until the battery is completely depleted.
2. Refrain from charging the Trimmer for a duration exceeding 2 hours.
3. Avoid leaving the cord connected to a power source indefinitely.
4. Deplete the battery fully twice per annum by allowing the motor to operate until it ceases.
5. Should the Trimmer go unused for an extended time frame, ensure it is recharged for a full 2 hours before use.

Trimming Guide

Cordless Trimming

1. Charge the Trimmer as per the instructions. Once charged, disconnect it from the power outlet and remove the cord.
2. Activate the Trimmer by sliding the ON/OFF switch to the ON position to start trimming.
3. After use, turn off the Trimmer by sliding the ON/OFF switch to the OFF position.

Note

1. Operate this Trimmer solely for the domestic purposes for which it is designed, as specified in this manual.
2. Prior to trimming, always groom your beard or mustache with a fine-toothed comb.
3. If you are trimming for the first time, proceed with caution and avoid moving the Trimmer too rapidly.
4. Employ smooth and gentle motions for best results.
5. Ensure the Trimmer is fully charged prior to use.

A. Trimming with the Hair Guide Combs

1. Attach the Guide Combs to the Trimmer before starting your trim, as detailed in Figure 1.

2. There are four guide combs: 3mm, 6mm, 9mm, and 12mm, allowing for different hair length settings.
3. If it's your first time trimming, begin with the comb set to the maximum length of 12mm to avoid trimming your hair too short by mistake. As you grow accustomed to the trimmer settings, you can then move on to the 9mm, 6mm, and 3mm combs to reach your preferred hair length. The guide combs will audibly "click" into their respective positions at each length setting.
4. To commence trimming, switch the Trimmer ON.
5. To achieve the most effective trim, maneuver the Trimmer in a manner that is opposite to the hair growth direction. It's essential to maintain the comb's surface in continuous contact with the skin, as depicted in Figure 2 and Figure 3.

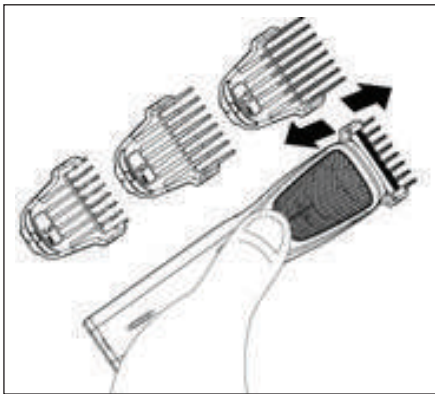

Figure 1

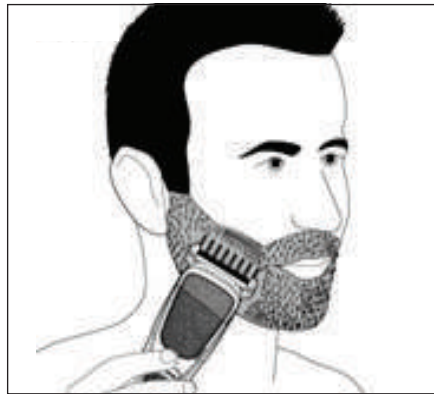

Figure 2

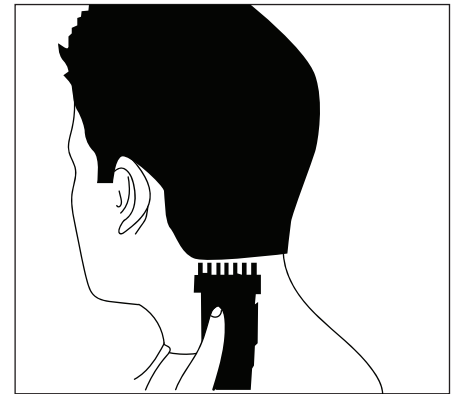

Figure 3

6. In the event that cut hairs accumulate in the comb, switch the Trimmer off, detach the comb and either blow gently to remove the hairs or give the comb a gentle shake (see Figure 4). Rest assured, the trimming length setting you've selected will remain unchanged during this process.

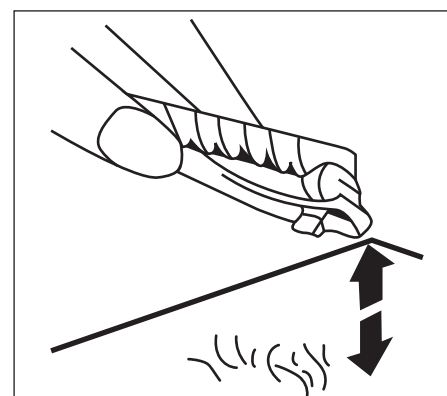
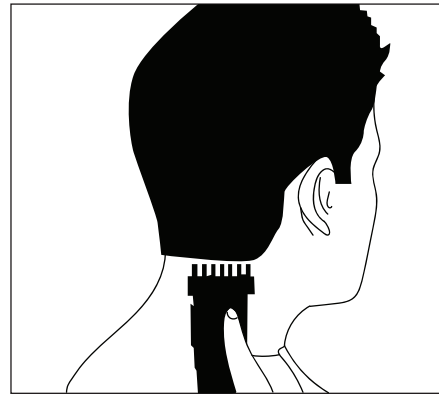

Figure 4

7. To Achieve the desired stubble look, ensure the Hair Trimming Comb is set to the Trimmer setting and select the 3mm comb.



B. Trimming Without the Hair Trimming Comb

Detach the comb when trimming the nape of the neck, lining up the hairline, and removing isolated or undesired hairs. To remove the comb, follow these steps:

1. Confirm that the Trimmer is switched OFF.
2. Disengage the Beard Trimming Comb by gently pulling it away from the Trimmer (See Figure 1).
3. Activate the Trimmer by turning it ON.
4. Execute controlled movements. Gently contact the hair/skin with the Trimmer (Refer to Figure 2 and Figure 3).

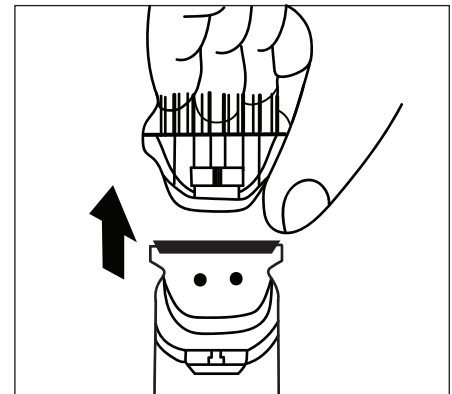

Figure 1

Note: Exercise caution while trimming without the comb, as the Trimmer will cut every hair it comes into contact with when powered on.

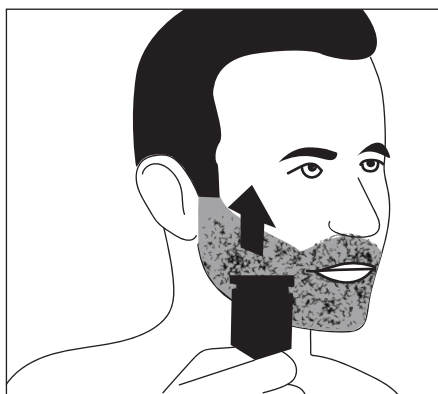

Figure 2

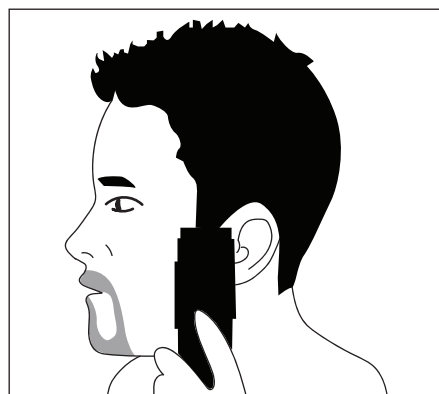

Figure 3

Nose and Ear Hair Removal

1. Attach the nose trimmer attachment.
2. Gently insert the personal groomer into the nostril or ear.
3. Carefully move the groomer in and out of the nostril or ear while simultaneously rotating it.

Note: Refrain from inserting the cutting unit more than 6mm into your nostril or ear.



Cleaning and Maintenance

1. Clean the Trimmer after each use.
2. Before cleaning, always turn the Trimmer OFF, disconnect it, and remove the power cord.
3. Do not submerge the Trimmer in water.
4. Avoid using harsh cleaning agents, abrasive materials, or strong solvents such as alcohol, gasoline, or acetone for cleaning the Trimmer and its attachments.
5. Never attempt to clean, swap, or detach the Trimmer comb while the motor is running.
6. Refrain from exerting pressure on the blades and avoid contact with hard objects to prevent damage.
7. To clean the handle of the Trimmer, use a soft, dry cloth.
8. **During Use:** In case there is an accumulation of cut hairs in the comb area, power off the device, remove the comb, and then clear away hairs by either shaking, blowing, or utilizing the provided cleaning brush.
9. **After Each Use:**
 - 9.1 Ensure that the Trimmer is turned OFF and unplugged from the electrical outlet.
 - 9.2 Detach the Trimming Comb and use the brush to clean it.
 - 9.3 Eject the cutting unit by pressing against its teeth (Refer to Figure 1 and Figure 2) and then rinse it under warm running water (See Figure 3 and Figure 4) or clean with the provided brush (See Figure 5).



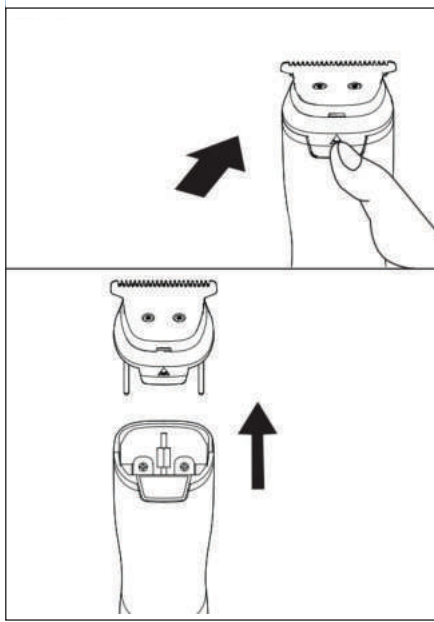

Figure 1

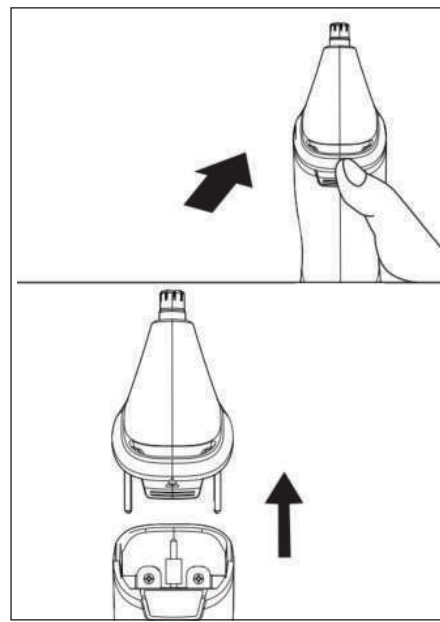

Figure 2

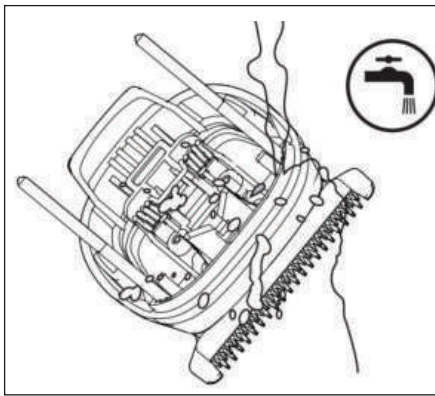

Figure 3

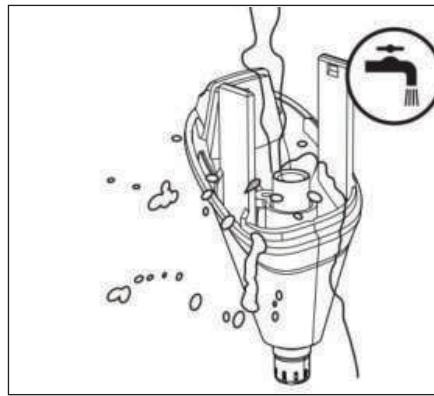

Figure 4



Figure 5

10. Important Note: Ensure the cutting unit is completely air-dried.

11. Reattach the cutting unit by aligning and inserting the notch of the cutting unit into the trimmer's guiding slot (See Figure 6 and Figure 7).

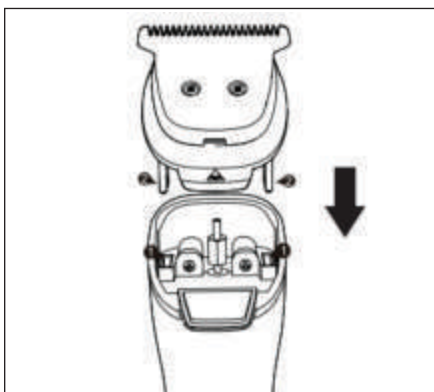

Figure 6

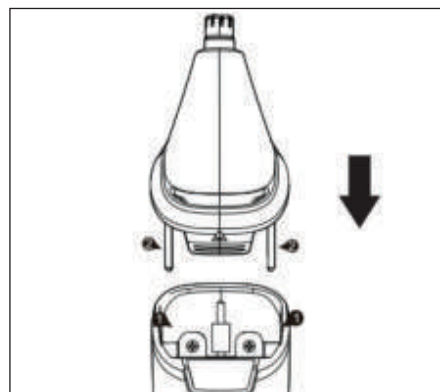

Figure 7

12. Secure the cutting unit into position on the Trimmer by pressing it down until you hear a clicking sound, confirming it is locked in place (Refer to Figure 8 and Figure 9).

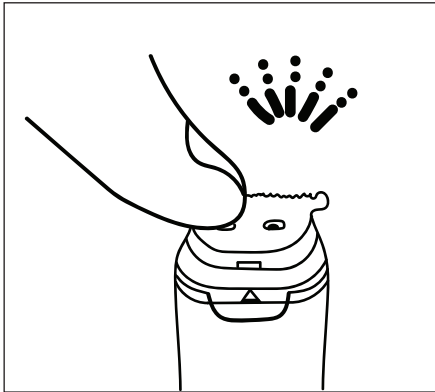

Figure 8

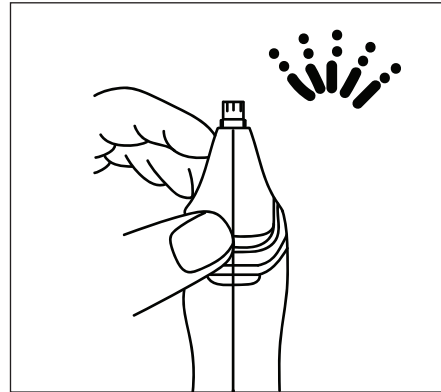

Figure 9

P Replacing the Cutting Unit

- 1.** Should the cutters become damaged or show signs of wear, cease using the Trimmer and replace the cutters immediately.
- 2.** Access the cutting unit by opening it.
- 3.** Detach the old cutting unit by applying pressure against its teeth (Refer to Figure 1 and Figure 2).

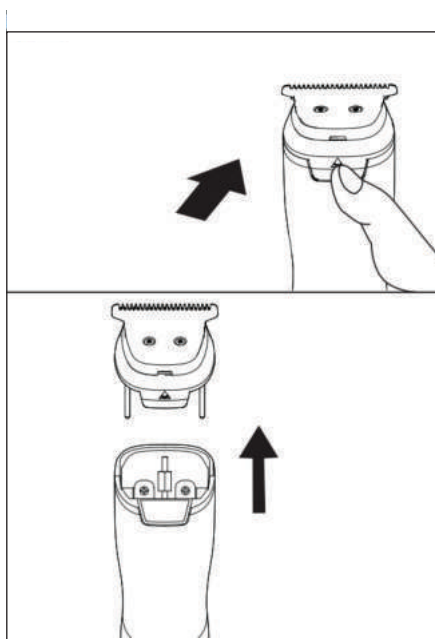

Figure 1

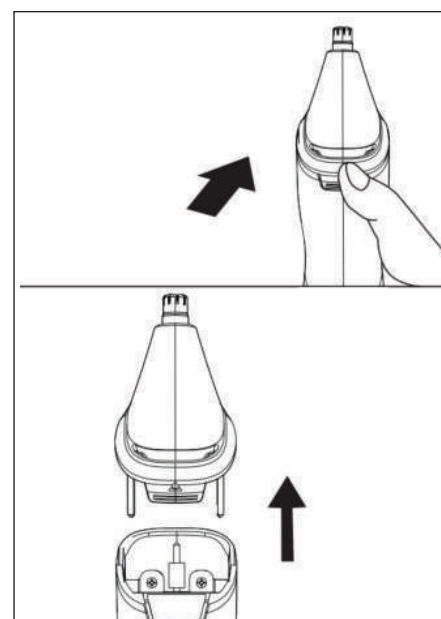

Figure 2

- 4.** Position the notch of the new cutting unit into the guiding slot (See Figure 3 and Figure 4).

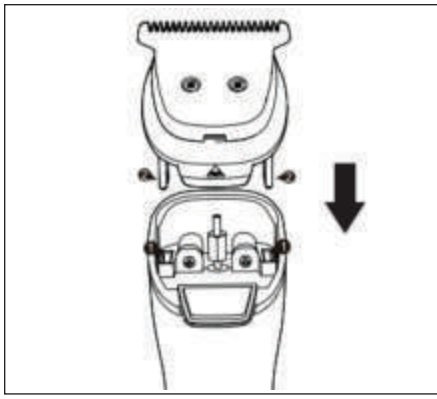

Figure 3

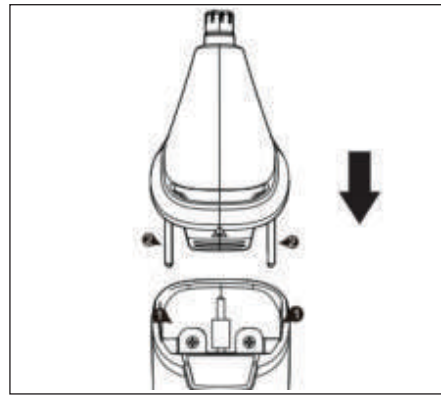

Figure 4

5. Reattach the cutting unit to the Trimmer, pressing until a 'click' is heard, indicating secure placement (Refer to Figure 5 and Figure 6).

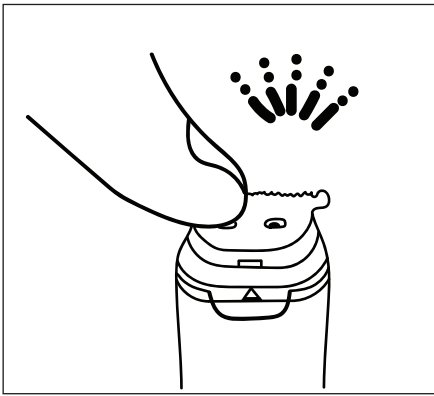

Figure 5

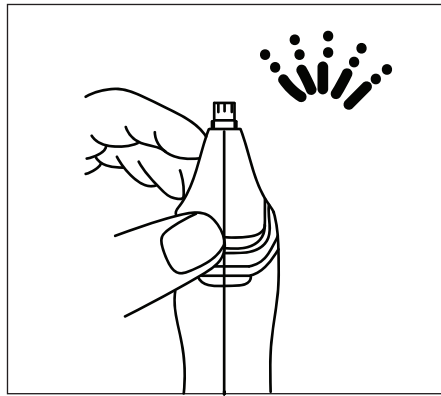

Figure 6

Safety Precautions

1. Do NOT immerse the machine in water, but it can be rinsed under a tap. (Refer to Figure 1)

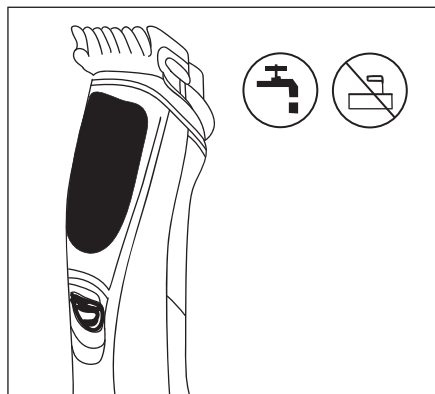

Figure 1

2. The trimmer attachment can be immersed in water or rinsed under the tap separately from the machine. (See Figure 2 and Figure 3)

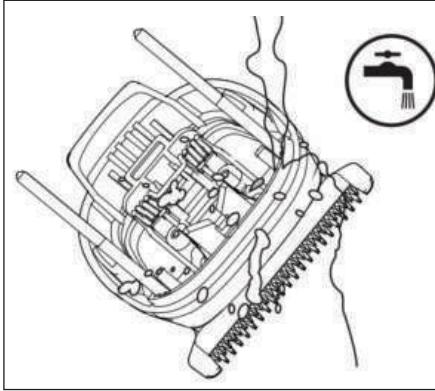

Figure 2

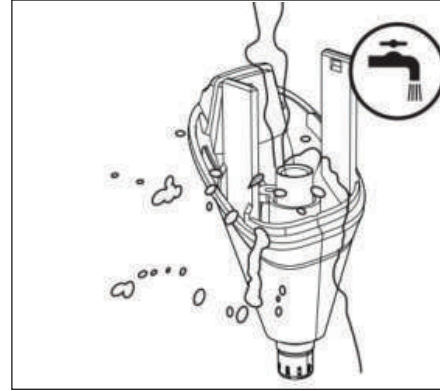

Figure 3

P Storage

- 1.** Ensure the Trimmer is turned OFF. Remove the cord from the outlet and Trimmer before storing it in a safe, dry location where it will not be crushed, dropped, or subjected to impacts.
- 2.** Avoid wrapping the cord around the Trimmer during storage.
- 3.** Store the cord in a safe location where it will not be cut or damaged.
- 4.** Do not place or store the Trimmer where it can fall or be pulled into a tub or sink, water, or other liquid.

Warranty

Products that you buy directly from our **Porodo** website or shop come with a 24-month warranty.

When you buy **Porodo** products from any of our approved sellers, you only get a 12-month warranty. If you want to extend this warranty, go to our website at **<https://porodo.net/warranty>** and fill out the form with your information. Don't forget to upload a picture of the product too. After we've checked and accepted your request, we'll send you an email to confirm that your product's warranty has been extended.

For more info, please check:

<https://www.porodo.net/warranty>

Contact Us

If you have any questions about this Privacy Policy, please contact us at:

info@porodo.net

Website: **porodo.net**

Service Support: **support@porodo.net**

Instagram: **[porodo](https://www.instagram.com/porodo)**